

Air Conditioning

Product Information

MSY-TP R32
High SHF Wall Mounted System
Inverter Heat Pump (Cooling Only)

Making a
World of
Difference

M series



The M Series **MSY-TP R32** High SHF wall mounted system blends energy efficiency with a modern white design. This cooling only unit has a high sensible cooling capacity, making it ideal for small computer rooms or areas that require a greater degree of sensible cooling. The MSY-TP also utilises low GWP R32 refrigerant.

Key Features

- Compact and stylish white design
- High sensible cooling ability
- Highly energy efficient, utilising low GWP R32 refrigerant
- Built in connection to our optional Wi-Fi interface, enabling control and monitoring using a smart phone, tablet or PC via the MELCloud app
- Weekly timer provides greater control of scheduling
- Cooling down to -25°C outdoor air temperature



Cooling | Heating | Ventilation | Controls

R32

Air Conditioning

Product Information

MSY-TP R32
High SHF Wall Mounted System
 Inverter Heat Pump (Cooling Only)

Making a
 World of
 Difference



MSY-TP - INDOOR UNITS		MSY-TP35VF	MSY-TP50VF
CAPACITY (kW)	Cooling (nominal) Cooling (UK)	3.5 (1.5-4.0) 3.47 (1.48-3.96)	5.0 (1.5-5.7) 4.96 (1.48-5.65)
SHF (nominal)		0.98	0.82
EER (nominal)		4.61	3.45
SEER (BS EN14825)		9.00	8.00
EP ENERGY EFFICIENCY CLASS	Cooling	A+++	A++
AIRFLOW (l/s)	Cooling - Lo-Mi-Hi-SHi	168-193-228-273	168-193-228-273
PIPE SIZE mm (in)	Gas	9.52 (3/8")	9.52 (3/8")
	Liquid	6.35 (1/4")	6.35 (1/4")
SOUND PRESSURE LEVEL (dBA)	Cooling - Lo-Mi-Hi-SHi	31-36-40-45	31-36-40-45
SOUND POWER LEVEL (dBA)		60	60
DIMENSIONS (mm)	Width x Depth x Height	923 x 250 x 305	923 x 250 x 305
WEIGHT (kg)		12.5	12.5
ELECTRICAL SUPPLY		220-240v, 50Hz	220-240v, 50Hz
FUSE RATING (BS88) - HRC (A)		10	10
INTERCONNECTING CABLE No. CORES		4	4

MUY-TP - OUTDOOR UNITS		MUY-TP35VF	MUY-TP50VF
SOUND PRESSURE LEVEL (dBA)	Cooling	45	47
SOUND POWER LEVEL (dBA)	Cooling	58	61
WEIGHT (kg)		34	34
DIMENSIONS (mm)	Width x Depth x Height	800 x 285 x 550	800 x 285 x 550
ELECTRICAL SUPPLY		Fed by Indoor Unit	Fed by Indoor Unit
PHASE		Single	Single
SYSTEM POWER INPUT (kW)	Cooling (nominal)	0.76	1.45
	Cooling (UK)	0.64	1.12
STARTING CURRENT (A)		3.6	6.4
SYSTEM RUNNING CURRENT (A)	Cooling [MAX]	3.6 [9.2]	6.4 [9.2]
FUSE RATING (BS88) - HRC (A)		10	10
MAINS CABLE No. CORES		3	3
MAX PIPE LENGTH (m)		20	20
MAX HEIGHT DIFFERENCE (m)		12	12
CHARGE REFRIGERANT (kg) / CO ₂ EQUIVALENT (t)		0.85 / 0.57	0.85 / 0.57
MAX ADDITIONAL REFRIGERANT (kg) / CO ₂ EQUIVALENT (t)		0.13 / 0.09	0.13 / 0.09

Notes: The SHF figures are based on nominal conditions. Requires an additional MAC-334IF-E interface and PAR-40MAA wired remote controller

PRODUCT DIMENSIONS

MSY-TP35/50VF

Front View

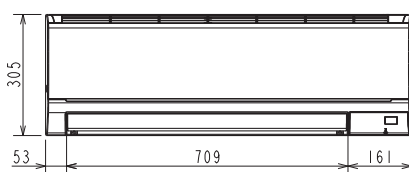

Upper View

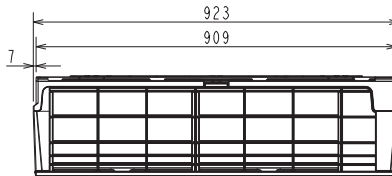

Side View

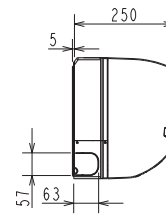

Telephone: 01707 282880
 email: air.conditioning@meuk.com
 web: airconditioning.mitsubishielectric.co.uk

UNITED KINGDOM Mitsubishi Electric Europe Living Environment Systems Division
 Travellers Lane, Hatfield, Hertfordshire, AL10 8XB, England General Enquiries Telephone: 01707 282880 Fax: 01707 278881

IRELAND Mitsubishi Electric Europe Westgate Business Park, Ballymount, Dublin 24, Ireland
 Telephone: Dublin (01) 419 8800 Fax: Dublin (01) 419 8890 International code: (003531)

Country of origin: United Kingdom - Japan - Thailand - Malaysia. ©Mitsubishi Electric Europe 2018. Mitsubishi and Mitsubishi Electric are trademarks of Mitsubishi Electric Europe B.V. The company reserves the right to make any variation in technical specification to the equipment described, or to withdraw or replace products without prior notification or public announcement. Mitsubishi Electric is constantly developing and improving its products. All descriptions, illustrations, drawings and specifications in this publication present only general particulars and shall not form part of any contract. All goods are supplied subject to the Company's General Conditions of Sale, a copy of which is available on request. Third-party product and brand names may be trademarks or registered trademarks of their respective owners.

Note: The fuse rating is for guidance only. Please refer to the relevant databook for detailed specification. It is the responsibility of a qualified electrician/electrical engineer to select the correct cable size and fuse rating based on current regulation and site specific conditions. Mitsubishi Electric's air conditioning equipment and heat pump systems contain a fluorinated greenhouse gas, R410A (GWP:2088), R32 (GWP:675), R407C (GWP:1774) or R134a (GWP:1430). *These GWP values are based on Regulation (EU) No 517/2014 from IPCC 4th edition. In case of Regulation (EU) No.626/2011 from IPCC 3rd edition, these are as follows: R410A (GWP:1975), R32 (GWP: 550), R407C (GWP:1650) or R134a (GWP:1300).



www.greengateway.mitsubishielectric.co.uk
 Mitsubishi Electric UK's commitment
 to the environment

Follow us @meuk_Jes
 Follow us @green_gateway

Mitsubishi Electric
 Living Environmental Systems UK

YouTube
[mitsubishielectric2](https://www.youtube.com/mitsubishielectric2)

BLOG
thehub.mitsubishielectric.co.uk

Effective as of December 2018